

1 Description

The EPI-LX-TH is a non-programmable thermostat for use with the STEP Warmfloor™ radiant heat system. The controller has three temperature control modes:

- A mode:** ▶ controls and displays the ambient air temperature

- F mode:** ▶ controls and displays the floor temperature using an external temperature sensor (EPI-LX-SEN)

- AF mode:**
 - ▶ controls and displays the ambient air temperature
 - ▶ maintains the floor temperature within desired limits using an external temperature sensor

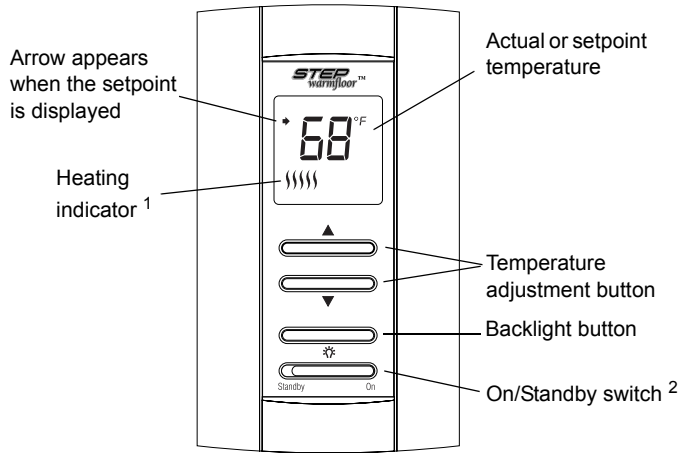

¹ The thermostat displays the percentage use of heating required to maintain the desired temperature. For example, is displayed when heating is at 40 percent.

Display					
% use of heating	1 to 24%	25 to 49%	50 to 74%	75 to 99%	100%

² Place the thermostat in Standby to cut power to the heater when it is not in use (e.g. in summer).

2 Configuration

The configuration switches are located at the back of the control module (faceplate).

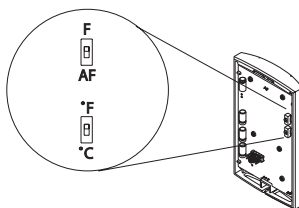

2.1 Temperature Display (S1)

The S1 switch is used to select between °F (default) and °C.

2.2 Temperature Control Mode (S2)

This switch is used to select the temperature control mode.

- F:** To select the F mode
- AF:** To select the A or AF mode (default)

3 Installation

- 1 Refer to the installation instructions of the EPI-LX-TH.
- 2 Insert the tabs at the top of the control module in the slots at the top of the power base.
- 3 Secure the control module using the captive screw underneath the base.

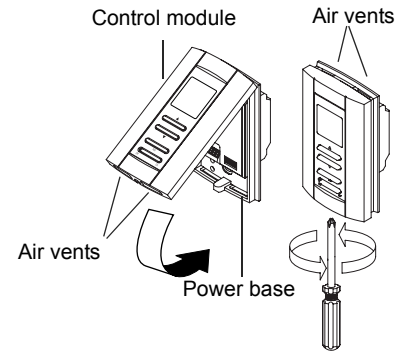

NOTE: Keep the thermostat's air vents clean and unobstructed at all times.

4 Power-up

Upon power-up, the thermostat undergoes a series of tests before displaying the actual (measured) temperature.



5 Error Messages



The measured temperature is below the thermostat's display range. Heating is activated.



The measured temperature is above the thermostat's display range. Heating is deactivated.



Verify the thermostat and sensor connections.

6 Backlight

The display illuminates for 5 seconds when the backlight button is pressed.

When either of the ▲▼ buttons is pressed, the display illuminates for 10 seconds. The setpoint temperature appears for 5 seconds, then the actual (measured) temperature is displayed.

7 Temperature Display and Setting

7.1 Setpoint Temperature

The thermostat normally displays the actual (measured) temperature. To view the setpoint, press once on one of the ▲▼ buttons. The setpoint is displayed for 5 seconds.

To change the setpoint, press one of the ▲▼ buttons until the desired temperature is displayed. To scroll faster, press and hold the button.

7.2 Floor Temperature Limits (AF mode only)

The thermostat generally turns heating On or Off to control the ambient temperature. However, if the floor temperature drops below the set minimum floor temperature limit or rises above the maximum limit, the thermostat will turn heating On or Off respectively, regardless of the ambient temperature, to maintain the floor temperature within the desired limits.

The minimum and maximum floor temperature limits are factory-set at 50 °F (10 °C) and 82 °F (28 °C) respectively. To modify the limits, proceed as follows:

- 1 Switch the thermostat to Standby.
- 2 While pressing any button, switch the thermostat back to On to access the floor temperature limit settings.
- 3 Press the Backlight button briefly to switch between minimum and maximum floor temperature settings.
- 4 Press the ▲▼ buttons to set the desired limit.
- 5 Press the Backlight button for 3 seconds to save your modifications. After the data are saved, the thermostat displays the actual ambient temperature or “— —”.

Note: Your modifications are also saved if no button is pressed for 60 seconds.

8 Technical Specifications

Power supply: EPI-LX-R power supply series with regulator

Setpoint range - **F mode:** 40 °F to 104 °F (5 °C to 40 °C)
- **A/AF mode:** 40 °F to 86 °F (5 °C to 30 °C)

Floor limit range (AF mode): 40 °F to 104 °F (5 °C to 40 °C)

Display range - **F mode:** 32 °F to 140 °F (0 °C to 60 °C)
- **AF mode:** 32 °F to 122 °F (0 °C to 50 °C)

Resolution: ± 1.0 °F (0.5 °C)

Duty cycle: 15 minutes

Storage: -4 °F to 120 °F (-20 °C to 50 °C)



Warranty

Electro Plastics, Inc. (EPI) warrants this product to be free from defects in the workmanship or materials, under normal use and service, for a period of three (3) years from the date of purchase by the consumer. If during the warranty period the product is determined to be defective, EPI (at its sole discretion) shall repair or replace it.

If the product is defective,

- (i) return it, with a bill of sale or other dated proof of purchase, to the place from which you purchased it, or
- (ii) contact EPI. EPI will make the determination whether the product should be returned, or whether a replacement product can be sent to you.

This warranty does not cover removal or reinstallation costs. This warranty shall not apply if it is shown by EPI that the defect or malfunction was caused by damage which occurred while the product was in the possession of a consumer. EPI's sole responsibility shall be to repair or replace the product within the terms stated above. EPI SHALL NOT BE LIABLE FOR ANY LOSS OR DAMAGE OF ANY KIND, INCLUDING ANY INCIDENTAL OR CONSEQUENTIAL DAMAGES RESULTING, DIRECTLY OR INDIRECTLY, FROM ANY BREACH OF ANY WARRANTY, EXPRESS OR IMPLIED, OR ANY OTHER FAILURE OF THIS PRODUCT. Some provinces, states or regions do not allow the exclusion or limitation of incidental or consequential damages, so this limitation may not apply to you. THIS WARRANTY IS THE ONLY EXPRESS WARRANTY EPI MAKES ON THIS PRODUCT. THE DURATION OF ANY IMPLIED WARRANTIES, INCLUDING THE WARRANTIES OF MERCHANTABILITY AND FITNESS FOR A PARTICULAR PURPOSE, IS HEREBY LIMITED TO THE THREE-YEAR DURATION OF THIS WARRANTY. Some provinces, states or regions do not allow limitations on how long an implied warranty lasts, so the above limitation may not apply to you. This warranty gives you specific legal rights, and you may have other rights which vary from province, state or region to another.

Customer Assistance

For any questions regarding product installation or operation, contact us at:

ELECTRO
plastics, inc.
d/b/a

STEP
warmfloor™

11147 Dorsett Road
Maryland Heights, MO 63043-3505
USA
Phone: (314) 426-3555
Toll-free: (877) STEP-TEC
Fax: (314) 426-3556
E-mail: design@warmfloor.com

For more information on our products, visit us at:
www.warmfloor.com